

BENDERS SVERIGE AB

# COMPANY PRESENTATION

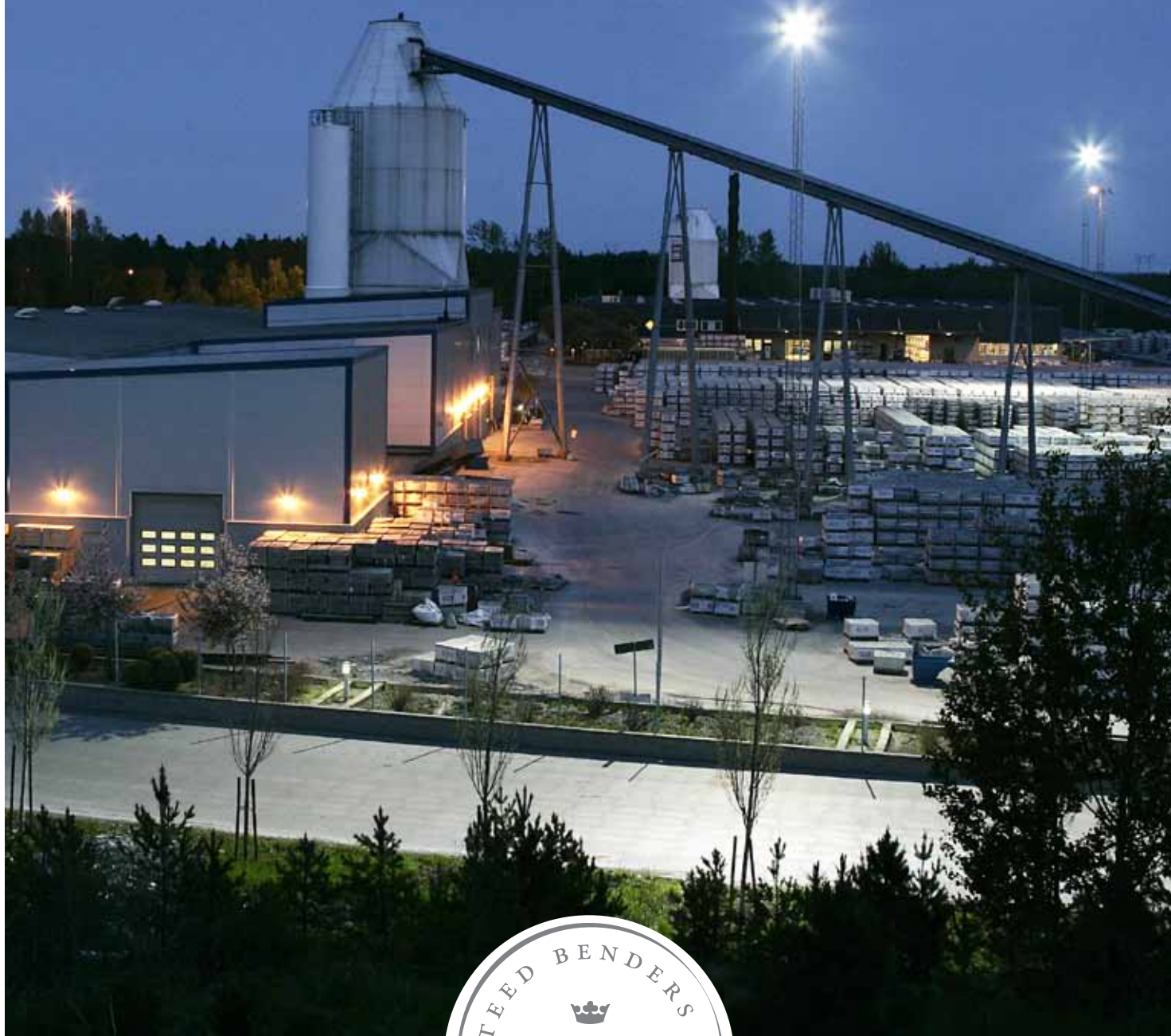

*The natural choice*

More about Benders  
[www.benders.se/en-gb](http://www.benders.se/en-gb)





BENDERS' IDEAS PARK, EDSVÄRA

# BENDERS SVERIGE AB

*This is Benders!*

Ever since starting in 1960, our ambition has been to satisfy customer needs. This has led to Benders establishing itself as one of the Nordic market's leading manufacturers in the product areas concerned. The new markets in Europe are becoming ever more significant. Our representation here is growing. We are also entering new business areas and, at the same time, will be expanding in all our present six main ranges. These are Roofing, Landscaping, Natural stone, Insulation, Walling and Infrastructure.

With a clear focus on personal commitment and decisiveness, our operations are permeated by a local presence and a local responsiveness to the business climate. Receptiveness is one of our key values and the basis of long and strong relations with customers and suppliers alike.

## Business idea and strategy

Benders' ambition is to be a strong, Swedish, family-owned company that develops, produces and markets competitive high-quality products and services for the construction and civil engineering sector.

Our customer relations shall be built on a long-term commitment in which great value is placed on knowledge of the industry, experience and personal service. Benders shall combine experience and expertise with inquisitiveness as regards new trends. We shall develop along with our customers. In this way, we shall create tomorrow's best products in our field and contribute to the long-term sustainability of an environment in which people live, work and socialise.



*Ove Bender, managing director*

To create the right conditions for expansion, and to cope with fluctuations in levels of economic activity, profits shall be reinvested in the company. Our operations shall be characterised by a strong commitment to our undertakings and a conviction that our work is beneficial for our customers and our environment.

The way we work shall be driven by the philosophy of tackling problems where they arise and thereby creating lasting improvements. We shall cherish a vision of continually developing our products, our technologies and our personnel in order to strengthen the Benders brand. We shall, in this way, be industry leaders in our product areas.



## *Ownership and geography*

Benders was founded in 1960 by Karl-Erik Bender. Today, the company is owned by Karl-Erik, his daughter, Helen, and his son Ove, who is also the company's managing director and the group manager. Our head office is still where Benders all started – Edsvära, just outside Kvänum in the Västergötland region of Sweden.

Edsvära is also home to one of the three Swedish production facilities for roof tiles. The two others are in Bålsta and Braås. Our two overseas facilities are in Germany and Greece. In addition to these, Benders has eight factories manufacturing paving stones and other concrete products in Sweden and the Nordic countries. Naturally enough, our Bohus granite production facilities are in the Bohuslän region of Sweden.

Out in Europe, we have warehouses, sales companies and distributors in some thirty places. Geographically spread manufacturing units and stocks are essential for environment-friendly production. Short distances for inward and outward deliveries, as well as closeness to ports and railways, are important factors.

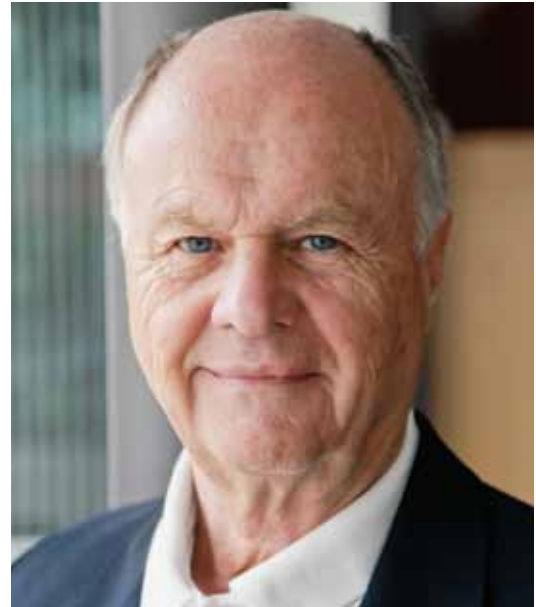

*Karl-Erik Bender, founder and chairman of the board*

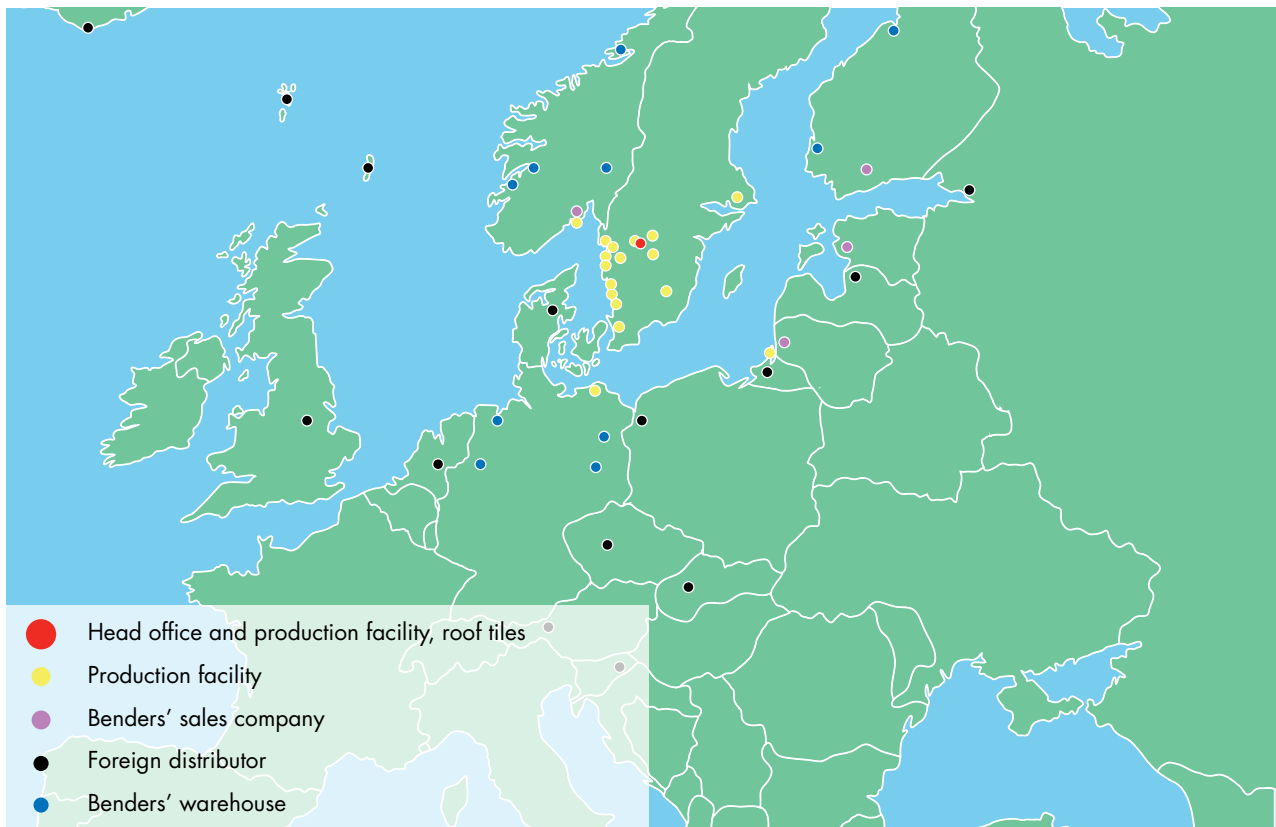

**Founder:** Karl-Erik Bender  
**Owners:** Karl-Erik, Ove and Helen Bender  
**Turnover:** approx. SEK 1,400 million (incl. partly owned companies)  
**Employees:** approx. 500  
**Head office:** **Edsvära**, Kvänum, where the company started  
**Prod. units:**

**Sweden**

- Braås
- Bålsta
- Edsvära
- Fjärås
- Floda
- Frillesås
- Götene
- Hjo
- Kvänum
- Nälinge
- Rabbalshede
- Skärholmen
- Uddevalla
- Vara
- Åstorp
- Ävja

**Norway**

- Sandefjord
- Logistics centre in Kongsvinger

**Greece**

- Karditza

**Germany**

- Kritzkow

**Finland**

- Mäntsälä

**Norway**

- Sandefjord

**Estonia**

- Pärnu

**Lithuania**

- Klaipeda

**Sales companies:**

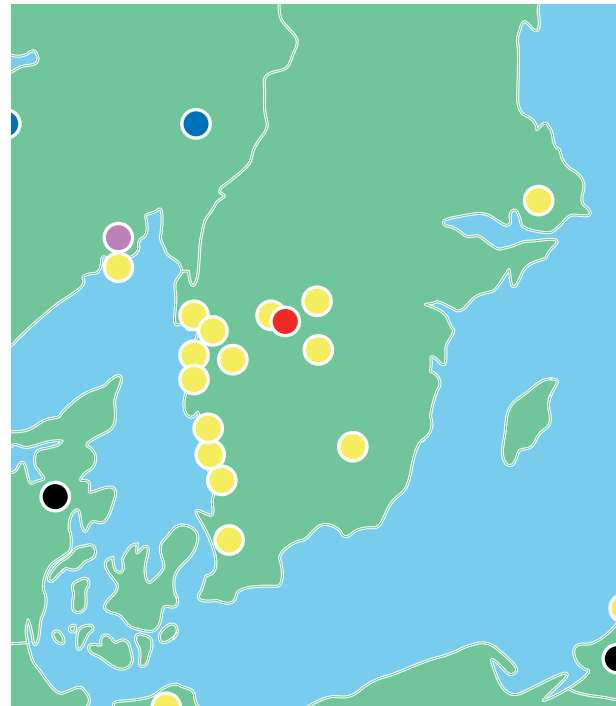

BENDERS IN SWEDEN



HEAD OFFICE IN EDSVÄRA

# IMPORTANT DECISIONS

Enthusiastic, expert employees have been a key in Benders' successful growth. Appropriate and punctual investments, initiatives and improvements have also been decisive. Some of these are shown below.



1962: Palema Fibber wins its first race.

1974: Knabe's year. This stallion from the Palema stables wins the "Åby Grand Prize" and other big races.

1986: Benders starts USA investment with factory in Florida.

1989: New factory in Braås, Småland, Sweden.

1960: First roof tile machine bought. Production starts. First horse bought.

1964: We are Sweden's largest roof tile factory.

1979: The new offices in Edsvära are ready for moving into.

1981: First roof tile delivered to Norway.



1960

1970

1980

### Benders group

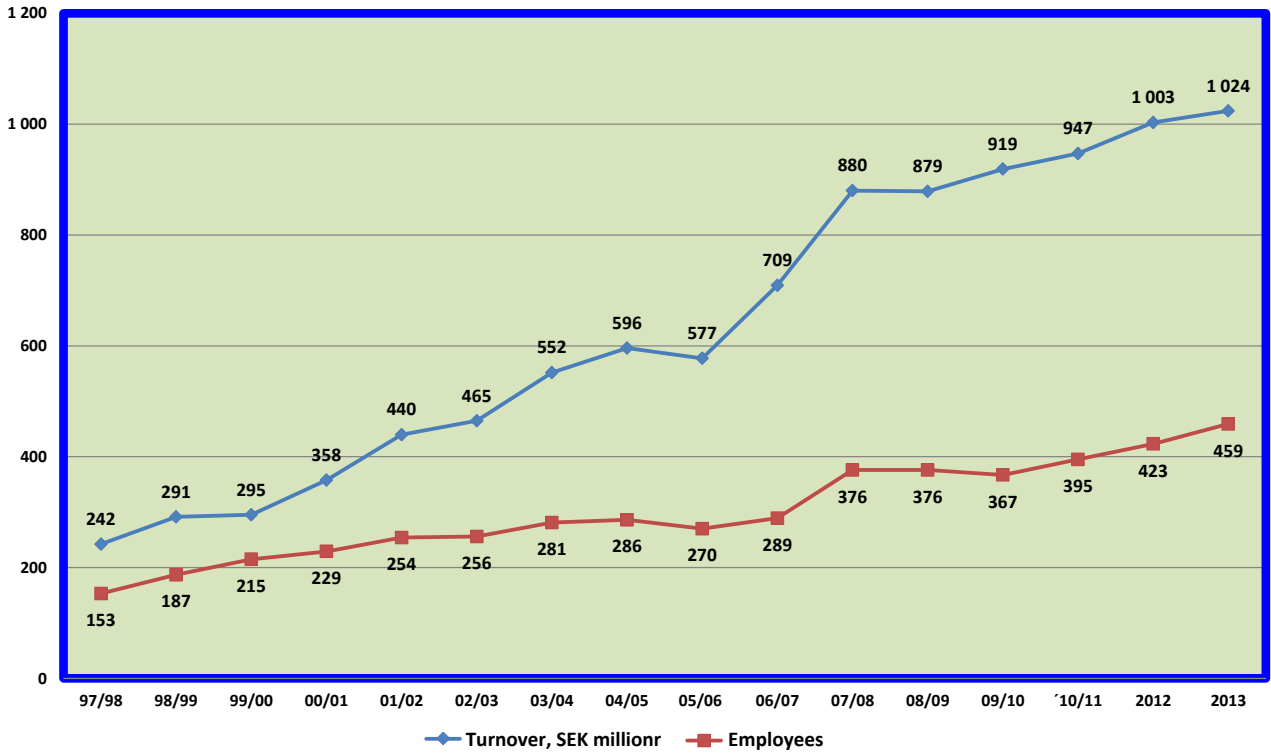

1995: Benders starts importing clay tiles.

1999: First jet plane purchased. Enables expansion in Europe.

2000: Benders sets up in Finland.

2004: Gidde Palema, Sweden's most successful trotter wins the "Solvalla International Elite Race".

2006: Benders buys Spikma Betong AB, manufacturer of kerbing, foundation and wall elements.

1992: Alf Palema wins the Hambletonian Stakes.

1993: KPAB in Kvänum acquired.

1998: Own manufacture of roof tiles starts in Germany.

2001: Roof tile factories built in Bålsta (Sweden) and Karditza (Greece). Start of paving stone business. Factories in Hjo and Frillesås bought.

2005: Landscaping unit in Bålsta opened. Roof tiles and paving stones now produced here. Paving stone factory in Fjärås purchased.

2008: Lasken Stein A/S, Benders' first production facility in Norway, bought.



1990

2000



## IMPORTANT DECISIONS



2010: Floda Cementgjuteri bought and becomes Benders' first factory producing L-retaining elements. The Kongsvinger logistics centre opens in Norway and Benders begins train investment.

2011: Uddevalla Cementgjuteri bought. Besides paving stones, slabs and walling systems, the factory also produces hollow concrete blocks, expanded clay blocks, hollow blocks, etc.

2012: Factory purchased in Åstorp to produce various products for public projects. A logistics centre is built. Benders also acquires Bohusgranit, a company with long traditions and exceptional products.

2013: In Uddevalla, Benders acquires a Volvo Car Group factory. The site covers around 1.5 million m<sup>2</sup> with buildings occupying 100,000 m<sup>2</sup> of this.

2014: Benders starts Benders Isolering AB, an insulation company producing cellular plastic in Vara.



2010

2015



# BUSINESS AREAS



**Construction and civil engineering products:** The products here are divided into six wide and comprehensive ranges – Roofing, Landscaping, Natural stone, Infrastructure, Insulation and Walling.



**Palema racing stables and stud farm:** Has roots going back to the 1960s and is one of Sweden's most successful stables. Horses such as Alf Palema and Gidde Palema are known throughout the sport.



**Property management:** This comprises management of our production and logistics facilities as well as of our other properties (e.g. former Volvo factory in Uddevalla).



**Benders Air:** The flexible air taxi service. From Skövde, our Cessna Citation Bravo quickly takes you to distant European destinations.

## CONSTRUCTION AND CIVIL ENGINEERING PRODUCTS



**Roofing range:** Benders' concrete roof tiles are the most laid concrete roofing in Sweden. Three different tile shapes are available with five finishes (natural being one of these) and in a large number of colours. We also have interlocking clay tiles in many different shapes and various colours.



**Landscaping range:** Benders offers the market's widest programme of products for your outdoor areas. Our production facilities in Sweden and Norway ensure wide availability of our paving stones, slabs, walling systems, etc.



**Natural stone range:** Walling system elements, street paving stones, kerb stones, claddings, work tops, posts, steps and public works of art in true Bohus granite. Benders' natural stone range also includes wide offerings of imported granite and Offerdal slate.



**Infrastructure range:** We offer a wide range of products for traffic environments. Spikma pinned kerbing and L and T-elements are just three of them. Four new sections have been added to our infrastructure range. These are: railways; water and sewage; electricity and telecommunications; and, multi-area projects.



**Insulation range:** For roofs, walls and foundations, Benders manufactures various grades (60 – 200 kPa) of cellular plastic that have unique properties. So that you can build your own foundations without any fuss, we also supply stable and easy-to-lay base elements.



**Walling range:** Benders' walling range has everything you need to build stable foundations, walls and retaining structures simply and efficiently.

# ROOFING RANGE



Benders' concrete roof tiles can now be found on six out of every ten houses in Sweden. Since manufacture started in 1960, over 1 thousand million tiles have been produced.

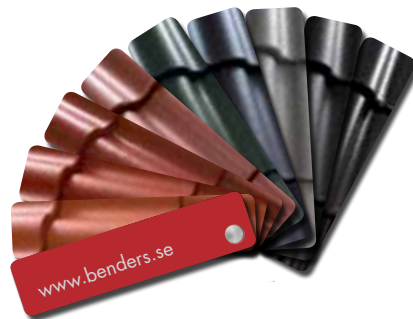

**Three concrete shapes:** Double pantile Palema is easy to lay, resistant and attractive. Traditional pantile Exklusiv gives your roof a stylish waviness. Carisma, our latest tile, is flat and tough.

**Three clay tile shapes:** Double pantile Tvilling is a product that makes laying easier. Traditional pantile Hansa is a modern development of the classic extruded clay tile. Piano is a flat, slate-like tile.

**Over 40 colours:** Black and red are the most popular colours in Sweden. For those who want to make a statement, there are over forty colours to choose from!

**Six finishes** (including natural): Would you like a high-gloss tile, one with a metallic pigment that reflects the light or an untreated one that has natural surface variations? We can supply these and more!

**Massive programme of accessories:** Benders' concrete accessories have the correct fit and colours for our normal tiles. Use cloak verges to give you the most attractive and easy-to-maintain roof possible!



**Logistics and unloading to roofs:** When laying a roof, it is a good idea to order delivery that puts the tiles right where you want them. This saves a lot of wear and tear on backs!

**Benders roofing systems:** Equip your roof with the right accessories for ventilation and safety. This ensures that your roof functions well and minimises the risks for anyone who works on it.







# LANDSCAPING RANGE

Concrete paving stones, slabs and walling elements are becoming ever more popular. On streets, town squares, garage drives, industrial yards and storage areas, concrete paving stones are increasingly replacing asphalt. The result is a prettier and more resistant surface. Furthermore, if you want, you can do it yourself!



**Paving stones:** When you want to build ecologically and beautifully, paving stones are the natural choice. We offer many different product families to choose from.



**Paving slabs:** Paving slabs are modern and attractive. They admirably set off other materials and plants. Especially in our wet-cast format (quadrangular or round), they often work well in functional settings. Our range also includes slabs for public projects.



**Kerb stones, blocks and plinths:** Constructing steps with stable Benders' blockstones is easy. Use Benders' kerb stones to connect a walkway.



**Decorative stones:** Finish your features off with attractive, decorative stonework. Available in several colours, shapes and formats.



**Walling elements:** Benders has a wide range of walling elements for both retaining and freestanding walls. Using our Geomesh, Benders' walls can be built really high.

**Landscaping accessories:** We offer a wide range of lighting in various designs and sizes. Do you like wrought iron? Our Royal wrought iron railings go perfectly with our walls. Now, we have even added glass railing panels to our range.



**Interlocking paving stones:** Paving stones are being used increasingly in industrial and heavily trafficked environments. From the technical point of view, interlocking paving stones can take both large point loads and torsional forces from, for example, work vehicles, lorries and buses. From the aesthetic point of view, paving stones offer every opportunity to create attractive surfaces that enhance buildings and surrounding areas.





# NATURAL STONE RANGE

With its unique colourings, tight fine-grained quality and light grey and light red tones, dressed Bohus granite will be found wherever you go in the Nordic countries. Walls, street paving stones, kerb stones, cladding, work tops, posts, steps and public works of art – all with the proud character of Sweden's rocky western coast. Benders' natural stone range also includes wide offerings of imported granite and Offerdal slate.



◀ **Street paving stones:** Paving stones last for hundreds of years and become increasingly beautiful with use – it cannot get any more environment-friendly than that! They go extremely well with granite slabs and are available in many formats and surface finishes.



▲ **Granite walling:** Beautiful walls that last for generations. All sorts of variants and designs are possible.

**Posts:** Our natural-cleft posts can be supplied to your dimensions and with holes for fitting chains or lighting fixtures. ▶





**Interior fittings:** Used for walkways, benches, work-tops and so on, granite works equally well outdoors and in. Interior fittings in granite are both hard wearing and beautiful. Furthermore, they stay where they are put!



**Kerb stones:** Granite kerb stones age gracefully and impress with their stylishness. They are manufactured in curved and straight formats. Several different dimensions and surface finishes are available.

**Art:** Granite offers countless possibilities. Let loose your imagination and give the right feel to your work of art!



**Granite cladding:** Ideal for façades and plinths where an imposing effect is sought. To create vibrancy, can be combined with other materials (e.g. wood).

**Blockstone steps:** Blockstone steps help set off your entrance. They are also impressive in public places. Available in three designs – Elegant, Modern and Rustik.



# INFRASTRUCTURE RANGE

The first pinnable concrete kerbing was developed in the 1970s. Today, with around 300 items in its range, Benders is the Nordic market leader in this field. Using in-house designed machines and extensive expertise in concrete for high-wear settings, these items are produced at our Götene factory. Our retaining wall elements are made in Floda and Åstorp. They have a carefully rolled surface and a tongue and groove design. We make L and T-retaining elements from 0.4 to 4.8 m high. They can be supplied with an angled top and in various lengths. The range does, of course, include corners. In Åstorp, we also make cable ducting and other railway products (e.g. those used for the tunnel through Hallandsåsen). We plan to add more products to this range.



◀ **Kerbing:** Our pinned kerbing is easy to replace if, for example, it is damaged during snow clearance. Available in five heights.

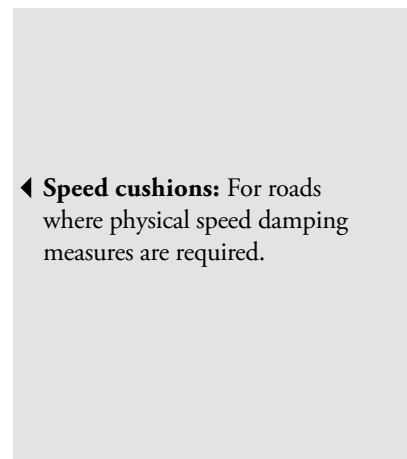
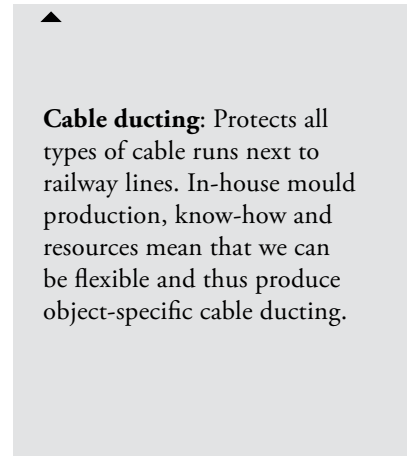





◀ **L and T-retaining elements:** Made with a grey, rolled surface and available in several different sizes. Load ratings are, respectively, 4 kN and 20 kN.



▶ **Concrete barriers:** Our concrete barriers can be used to create obvious boundaries (e.g. at entrances) or to provide bases for signs.

◀ **Kerbing accessories:** Scissor grabs, chipping hammers, pin guns, et cetera – we have the tools for installing the products from our infrastructure range.  
◀ Buy or hire as you wish.



◀ **Bus stop kerbing:** Serves to help form a raised pavement. Buses are guided safely in along the smooth kerbing. Saves wear on bus tyres.

◀ **GCM kerbing:** GCM kerbing is used to separate different traffic streams (e.g. pedestrian/cycle routes from roads).  
▼



◀ **Wide kerbing:** A stable kerb for interfaces between two levels.





# INSULATION RANGE

So that you can build stable, secure foundations easily, Benders supplies in-house manufactured cellular plastic in combination with base elements. We can supply all common dimensions of cellular plastic and grades from 60 to 200 kPa. Bender Sockelelement (base elements) have a rustic brushed finish, are insulated and are ready for laying. Their low weight and perfect fit make them the natural choice.



◀ **Expanded polystyrene (EPS) panels/sheets:** Our EPS (cellular plastic) panels/sheets insulate and protect against the wind. For roofs, walls and foundations, they are available in various grades from 60 to 200 kPa.



**Base element shapes:** Our easy-to-lay base elements are supplied in various sizes, insulated with 100 mm EPS. They are available in L, I and U formats.

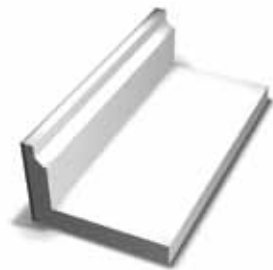
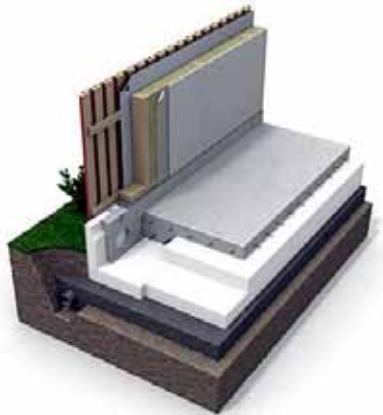

**L-base elements:** One of our major sellers. It is available in several load classes and formats.



**I-base elements:** Used in additional insulation for existing foundations or where no insulation is required under footings.

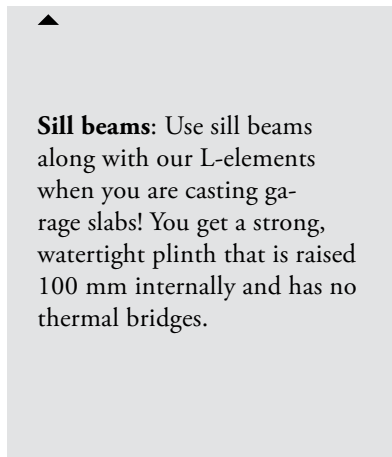

▲  
**Sill beams:** Use sill beams along with our L-elements when you are casting garage slabs! You get a strong, watertight plinth that is raised 100 mm internally and has no thermal bridges.



**U-base elements:** Can be used for warehouses, garages and factories with particular insulation requirements.



◀ **Benders Isolering AB:** On acquiring machines and premises at Vara, Benders Sverige AB started Benders Isolering AB in June 2014. The new company produces insulation.



# WALLING RANGE

Benders' walling range has everything you need to build stable foundations, walls and retaining structures simply and efficiently.



**Expanded clay blocks:** Classic, ergonomic blocks that are ideal for foundations, walls, garages, outdoor areas and even entire houses. The blocks have good insulation properties and are frost-resistant. Available in several sizes with a choice of widths. ▶



▶ **Expanded clay beams:** Used above windows, doors and other openings. The beams are strengthened with intertwined reinforcement bars. Available in several widths and lengths.



▼ **Hollow blocks:** Strong wall blocks that withstand large stresses. The blocks simply stack on top of each other with no mortar.



◀ **Hollow concrete blocks:** Thanks to the strong and stable design, hollow concrete blocks make good walling. The smooth concrete surface is excellent for painting without plastering.





◀ **Walling blocks:** Our ready-to-use walling blocks ensure streamlined and economic building. Using a running bond that has its horizontal joints bonded and the vertical ones sealed with tape, the blocks can be put together like a “Lego system”. The blocks are made of high quality (K60) concrete with a brushed exterior and smooth interior. They give a well-insulated, hard  
▼ wearing and very durable wall.





# PALEMA RACING STABLES AND STUD FARM

One of Sweden's most successful trotting stables of all time, **Stall Palema** is part of the Benders group.



◀ **The horses:** The most successful Palema horses are Hambletonian Stakes winner Alf Palema and the two "Solvalla International Elite Race" champions Gidde Palema and Torwald Palema.



▲ **The stables:** Stall Palema currently has seventy horses. Some twenty of these compete in Sweden and fifteen in the USA.

▲ **The stud farm:** One of Sweden's most successful stud farms of all time, Stuteri Palema has raised 25 horses that have each taken SEK 1 million in winnings.



# PROPERTY MANAGEMENT

Benders has several strategically located logistics centres, factories and warehouses. The aim is to be as close to our customers as possible. On page 3, there is map showing all our facilities.



◀ **Åstorp:** In Åstorp, we have southern Sweden's most complete facility for construction and civil engineering products.



**Kongsvinger:** Kongsvinger is a complete facility for our Norwegian market. Paving stones for Kongsvinger are loaded at Bålsta. The return train carries sand and gravel from Kongsvinger's gravel pit. Each of these trains is the equivalent of 35 fully laden articulated lorries.



▲ **Uddevalla:** Our entire range of natural stone and expanded clay products is now available from our logistics centre in Uddevalla.



◀ **Bålsta:** Bålsta is the hub of our distribution network. Production of landscaping and roofing products here means that complete ranges of both are available. Distribution is then by train or lorry to Norway, Finland and Benders' units in Sweden.



# BENDERS AIR

Benders Air is the tiny airline with giant service levels! Our philosophy is that you should be able to tailor your air journey to your unique needs and wishes. Travelling with us is time-efficient and flexible. Exactly as you would expect!



**From door to door:** Our Cessna Citation Bravo opens up the possibility of attending a daytime meeting somewhere in Europe and then being back home in time for the kids' football training in the evening. Alternatively, let us take you, your family and your friends on a relaxing weekend of sunshine and lazing or a city stay with shopping and fine food!



**The customers:** We fly everyone from rock stars to company managers. Two hours gets you to most parts of Europe.



**The pilots:** Our pilots look after you and your party and help with all the practical things involved in the journey.

# TRANSPORT AND LOGISTICS

The Braås Åkeri haulage company has been Benders road transport supplier for many years. It has the experience, vehicles and equipment necessary for ensuring dependable deliveries.

Benders own investment in rail transport (container system included therein) has won the DB Schenker Logistics Award, the industry's most prestigious prize.



**Planning:** Braås Åkeri has its staff in Edsvära. In the busy season, the telephones get very hot and up to 300 lorries depart with loads from our warehouses every day.



**The warehouses:** So that we can rapidly deliver most of our products directly to building sites, we always carry large stocks.

**The crane lorries:** In their striking blue and red liveries, you have certainly seen them on the roads. The cranes have a reach of 18 metres and can place pallets wherever you want.



**Trains:** Our long experience of train transport enables efficient and environment-friendly deliveries to customers.



# QUALITY AND ENVIRONMENT

Benders has had an environmental certificate since 1999 and was also the first company in Sweden to achieve environmental certification for a roof tile manufacturing operation. We have a deep concern for the environment. Before implementation, we carefully weigh the environmental impact of our decisions. Benders is affiliated to FTI (a nationwide recycling system for packaging) and registered with BASTA (guidance on sustainable construction materials) and SundaHus (leading system for health and environmental assessments of products within the construction and real estate industry).



◀ **Colourings:** To ensure optimum environmental safeguards, we manufacture all our colourings ourselves.



◀ **Water:** Water used in cleaning during production is recycled in the mixing of new products. At most of our facilities, water is taken from our own wells.

**Recycling:** Benders' recycling programmes cover everything from paper to crushed concrete products.



◀ **Cement:** Our cement comes primarily from Cemente, a world-class operation as regards environmental investment in cement production. We have worked with this company since Benders started in 1960.

◀ **Sand, gravel and granite:** These are taken from nearby quarries/pits and are screened to the right sizes for optimum product quality.





◀ **Reasons for choosing Benders:**

We are the largest on the market. This gives a security that is appreciated by many. Through our network of distributors, we are near you, the customer. Both physically and emotionally, our staff are also close to the company. We love our materials and put all our energies into maintaining complete ranges and providing you with good products at the right price, at the right time.



**STAR FOR LIFE**

**30**

**10**

◀ **Roof guarantee:** When you buy a complete concrete-tile roof with original accessories from Benders, you also get a 30-year guarantee covering strength, watertightness and frost resistance.

◀ **Landscaping product guarantee:** The products in our landscaping range are of a uniformly high quality that withstands many years of attrition in tough conditions. Our slabs and paving stones have a full 10-year guarantee.

▲ **Social commitment:** Since 2011, Benders has been working closely with Star for Life, an organisation that helps children and adolescents find self-esteem and develop a healthy lifestyle. Star for Life has been active in schools in South Africa, Namibia and Sri Lanka since 2005. In 2014, it also started working in Swedish schools.  
[www.starforlife.se](http://www.starforlife.se)

▶ **Ecoline:** Many of our products are available as Ecoline variants. These have titanium dioxide additives that, throughout the entire lifetimes of the products, convert harmful nitrogen oxides in the air into harmless nitrate.

▶ **CE marking:** Our CE documents are readily available on our website, [www.benders.se](http://www.benders.se).

**ecoline**



**Ethical requirements:** Benders places great importance on ensuring that the commercial goods from its suppliers are produced and certified in an ethical and correct way.





**HEAD OFFICE**

Benders Sverige AB  
Box 20

SE-535 21 Kvänum

**Offices:** Edsvära

**Tel:** +46 (0)512 78 70 00

**Fax:** +46 (0)512 78 70 19

**Email:** [info@benders.se](mailto:info@benders.se)

**Website:** [www.benders.se/gb](http://www.benders.se/gb)